

T-2700 / A-3283 Stabilizer Mounting Instructions

- 1) Assemble brackets/hardware to stabilizer per the illustrations below. Allen headed set screws should not stick all the way through the bracket. These are tightened after the bracket is in place.
- 2) Turn steering wheel to the extreme LEFT, this moves the tie rod to the farthest point to the right.
- 3) Extend damper to full travel
- 4) Attach damper bracket to bottom of the tie rod. On model T's, the stabilizer mounting hole should be 16" on center from the center of the tie rod bolt. On model A's, the stabilizer mounting hole should be 13-1/2" on center from the tie rod pivot ball.
- 5) Clamp rod end (axle end) of the stabilizer bracket to the axle with stabilizer fully extended.
- 6) Turn wheels back to the left and check clearance of all brackets. If brackets are hitting, move stabilizer brackets to correct.
- 7) Once you are sure brackets are in correct location and nothing is hitting, tighten the allen headed set screws on each of the aluminum mounting brackets.

TIE ROD END

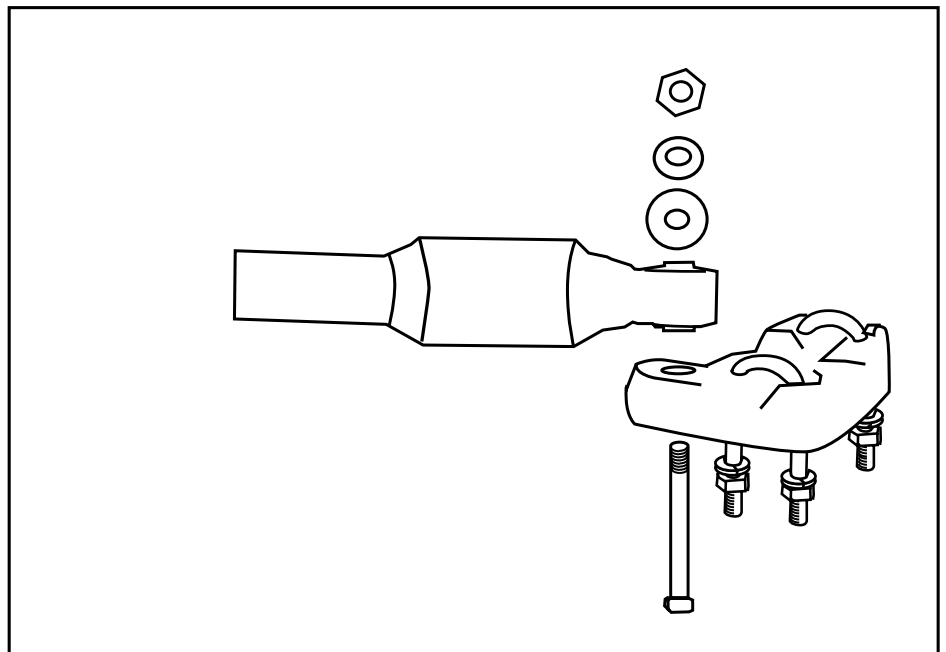

AXLE END

